



Gamesman

GPB1181 Push Button Product Specification

Issue 02: Date 05.01.2021



Disclaimer:

The information provided within this product specification is intended only to make the reader aware of the product's technical data and its use thereof. As such, Gamesman Ltd shall not be held liable for any loss or damage to the assembly or component within, arising from its misuse or from the unintended use of information or particulars included within, or any omission from, this document.

Design and specifications are subject to change without notice.

Failure to observe the interface requirements specified in this document may result in damage to the electronics and resultant performance characteristics of the product.

1. Product Dimensions

a) General Dimensions

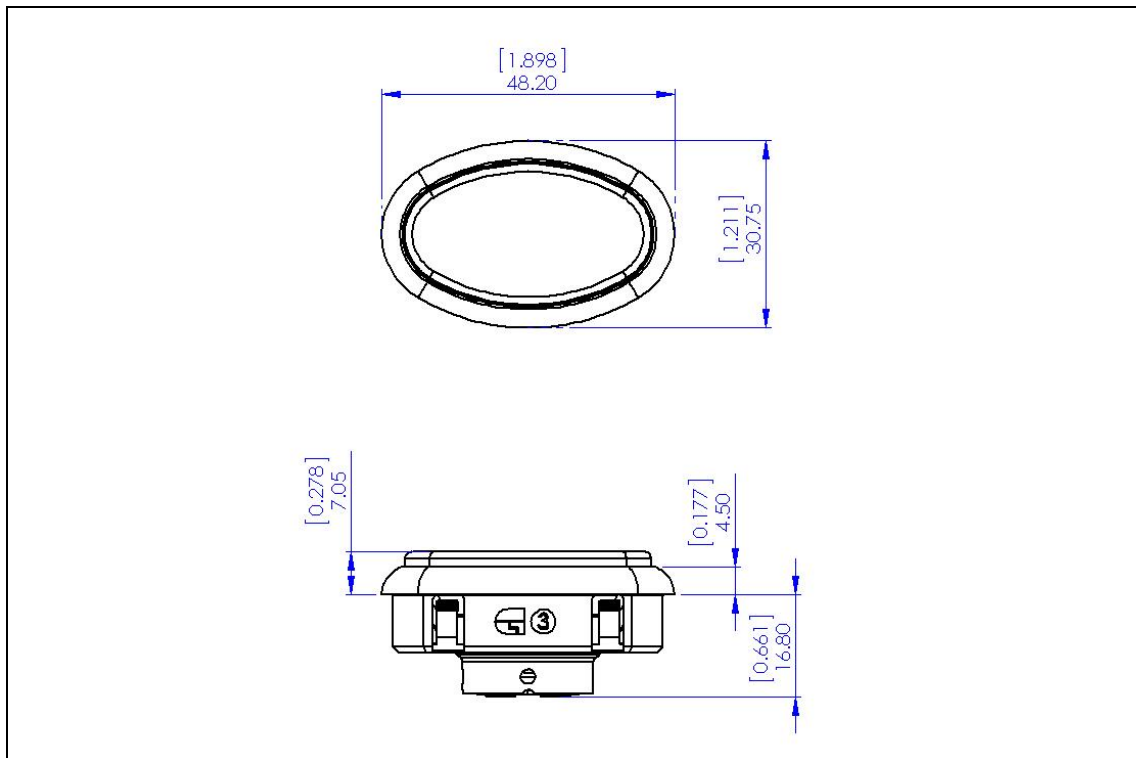

b) Insert Dimensions

c) Panel Cut out Details

<p>Technical drawing of the insert showing dimensions: $[1.205]$ R30.6 MAX, $[0.275]$ R7.0 MAX, = 24.0 CTRS =, $[1.494]$ 38.0 MAX, $[0.807]$ 20.5 MAX, = 40.7 CTRS =.</p>	<p>Technical drawing of the panel cut out showing dimensions: $[1.337 \pm 0.002]$ R33.95 ± 0.05, $[0.406 \pm 0.002]$ R10.33 ± 0.05, $[0.945 \pm 0.002]$ 24.00 ± 0.05 CTRS, $[1.758 \pm 0.002]$ 44.65 ± 0.05, $[1.071 \pm 0.002]$ 27.20 ± 0.05, $[1.602 \pm 0.002]$ 40.69 ± 0.05 CTRS =.</p>
<p>Insert Material - Acetate sheet or similar.</p> <p>Insert Thickness – 0.20mm [0.008"] Minimum – 0.25mm [0.010"] Maximum</p>	<p>Panel thickness range:</p> <p>1.40mm [0.055"] \pm 0.1mm [± 0.004] to 2.00mm [0.079"] \pm 0.1mm [± 0.0042]</p>

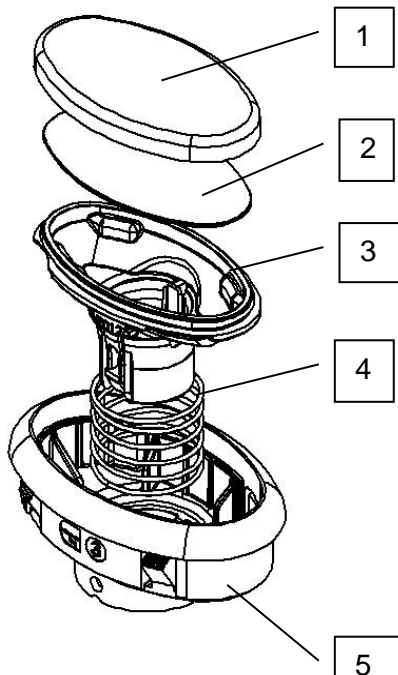

2. Product Identification

	No.	Part Number	Description	Material	UL94 Rating
	1	GMP01254	Lens	Polycarbonate	V2
	2	GMP01253	Legend Plate	Polycarbonate	V2
	3	GMP01252	Plunger	PBT	HB
	4	G4-950	Spring	Spring Steel	N/A
	5	GMP01251	Bezel	Polycarbonate See Note 1.	V2

Item 5 is available in various colours, see specification sheet for the options.
Minimum Order Quantities may apply.

3. Product Compatibility

a) Switch System –

System U3	
System U4	

b) [LED Solutions](#)

Please refer to the link for the latest LED Capsules supported by the switch systems listed above.

4. Accessories

<p>Extraction Tool for Button Order Part Number GMP01582</p> <p>This extractor is to be used to remove the GPB1181 push button from a panel</p>	
---	--



Gamesman

GAMESMAN LTD

CROMPTON FIELDS, CROMPTON WAY, CRAWLEY, WEST SUSSEX, RH10 9QB
TEL: +44 (0) 1293 418888 FAX: +44 (0) 1293 418880

REGISTERED IN ENGLAND NO. 3027138

Website: www.gamesman.co.uk

E-mail: sales@gamesman.co.uk